



Imagine the best, done!

Why VESTA?

**10** Reasons



# 1

## No training required

- Easy installation with step-by-step wizard
- Automatic reading of EOL resistors
- Single App for user and installer, compatible with all panels
- Intuitive programming and kits with pre-configured peripherals
- Simple and efficient web portal (Vesta and ByD)
- No expert support required, ideal for inexperienced installers



# 2

## Increased profit

- Competitive pricing
- Highest RPS in the market, offering more peripherals and integrations than other brands, especially in CCTV
- Constant upgrades to maintain innovation
- New and exclusive brand not mass-marketed
- Stock and technical support close to the customer
- Grade 2 and Grade 3 certified



# 3

## Covers all needs

- Diverse alarm panels with options such as the affordable WiFi Hub, battery-powered panel, wireless black box (grade 2), touch panel (grade 2), or hybrid control panels (grades 2 and 3)
- Home automation, Zigbee, Z-Wave, WiFi and Bluetooth integration
- AlarmSpace software to improve ARC efficiency



# 4

## Endless options

- Broad portfolio of peripherals, including keypads, PIRs, PIRcams, door and window sensors, keyfobs, security sensors and sirens
- Advanced integration: compatible with Zigbee and Z-Wave for home automation, LoraWan for security, Optex for outdoor devices, Wiegand for Access Control and Hikvision and Dahua for video
- Customisable options: multiple colours and variants
- OTA updates to keep devices up to date



# 5

## Exclusive benefits

- Direct Optex bus integration and easy memorising without opening the detector
- Special wireless peripherals: multi-purpose sensors, indoor/outdoor HD Pircams, Mesh repeaters and outdoor Optex Pircams
- Special feature panel: zone expanders with battery back-up, automatic EOL reading, and Sleep Tight and Hands-Free Entry features
- Wireless protocol with two-way voice
- Easy cleanability and dust immunity on smoke detectors, 10-year life on CO sensors, and programmable rules



# 6

## Highest security

- Simultaneous 4G, Ethernet, LoRaWAN (non-blocking) and WiFi communication
- Zone expanders with battery backup, video integration (Dahua/Hikvision) with analytics and Access Control with Wiegand reader
- Enhanced security: wall panic buttons and customisable rules such as delayed opening for bank safes
- EN50131 Grade 3 with Triple EOL
- Grade 3 HD Pircams



# 7

## Interface Customisation

- Customised contact information
- Login banner logo
- Application logo

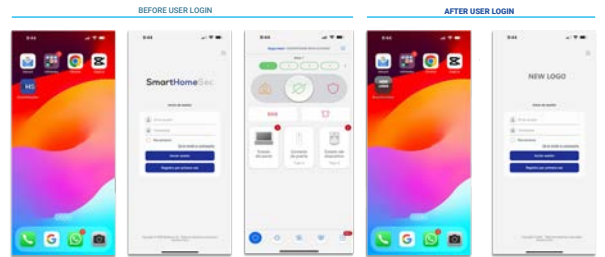

# 8

## Video integration

- Full integration with Dahua, Hikvision and VESTA cameras
- Advanced video analytics, live and recorded video accessible from the App
- Alarm images stored in the VESTA Cloud
- NVR with analytics and time synchronisation
- SD cards in cameras



# 9

## Integration in ARC

- Bridge to ARCs: software upgrade, with local installation and protocol conversion for legacy systems
- Advanced features: automatic voice calls to end-users, analytics on PirCams (human detection)
- Improved image quality, night-time colour images sent to both ARCs and end-users (App)



# 10

## ADC VIP Partner

- VESTA as a key partner in EMEA, being the only one with unique ADC products and designs
- Full compatibility between VESTA's radio peripherals and ADC products
- Highlights: fast enrolment with no templates, best radio path in the market, PirCam with anti-masking, integrated in-panel power supply, and support for Zigbee, Zwave and BLE
- Healthcare peripherals





# SHS App SmartHomeSec

Remote control of your systems security and home automation

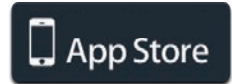

## Many functions in a single App

VESTA SmartHomeSec application you can remotely control and manage both your security and video surveillance system and the smart devices in your home or business.



Also available installer section for configuration and advanced management of the system from the mobile!